

Efficient reference manual production using WeAllEdit

About Danfoss Floor Heating Electrical

Optimisation of business workflow is a key concept for any company – including Danfoss Floor Heating Electrical. The company, which up until 2003 was known as DEVI, is Europe’s leading manufacturer of intelligent floor heating systems for both internal and external use. The company is part of the world’s largest competency centre for floor heating which Danfoss has established in Vejle. Danfoss Floor Heating Electrical employs 500 staff, 300 of whom work in Vejle. Ninety percent of total production is for the export market.

LanguageWire’s graphic system WeAllEdit has significantly enhanced the efficiency of the company’s reference manual production. Whereas a graphic employee used to work with one manual at a time, it is now possible to have several projects going at once.

The challenge

As a general rule all product reference manuals are produced in English.

Previously the production procedure involved sending a Word file to company subsidiaries, which then translated them into the different national languages. The text was then returned to Vejle where desktop publisher Anne Hansen loaded the document into the reference manual. Following text adjustment, the manual was returned to the subsidiaries in PDF format for final approval.

“Sometimes the text went back and forth as many as five or ten times. When the translators saw which photographs were to be used the text often had to be changed to fit the images. In many cases the changes took the form of hand-written comments on scanned documents,” explains Anne Hansen.

The solution

WeAllEdit greatly simplifies the process. When the reference manual is ready, it is uploaded into the WeAllEdit system. The individual subsidiaries are then informed and can access their own file containing all the details online and translate directly in the file. When they have finished, Anne Hansen is informed. She then adds the final graphic touches and sends the PDF file off for final approval.

Once the file has been approved, the file is entered into Danfoss’ print-on-demand system. This ensures that only the required number of manuals is printed. If seven specific products are ordered for Russia, the seven corresponding reference manuals are ordered at the same time.

“WeAllEdit is incredibly user-friendly. We have not had to use extra resources to train our colleagues in the subsidiary companies. After having seen the WeAllEdit demo, they were immediately able to use the system,” asserts Anne Hansen, who goes on to express her immense satisfaction with the support and service she has received.

“In my view, WeAllEdit is a global product which can be used everywhere by everyone. The time saved is considerable and quality is ensured throughout the process.”

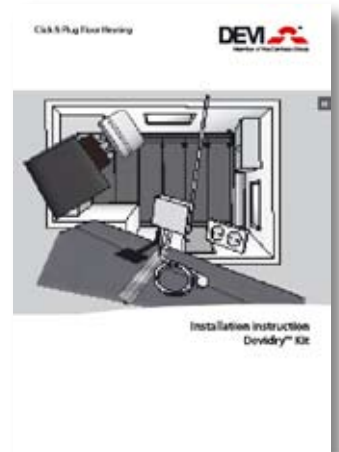

Signature explanation

11	Read manual
12	Reading element necessary for installation on top of concrete floor construction prior an excessive floor cover embedded in concrete floor, only floor installed in concrete.
13	The Devicely™ element may be used beneath the actual area, as there are no other floor joints in the area.
14	The Devicely™ element cannot be cut here as there are electrical parts in the area.
15	Read the instruction manual before installation.
16	Double insulation
17	Devicely™ is marked by CE.
18	CE Marking shows that Devicely™ is tested according to the standard for variable loads: EN 60730-1-1:2004 and variable electrical appliances - Safety - Part 1: General safety requirements and EN 60730-2-1:2004: Installation and double circuit of appliances - Safety - Part 2: IEC will give the technical aspects and testing rules for more testing provided to user separately. These are in separate documents.

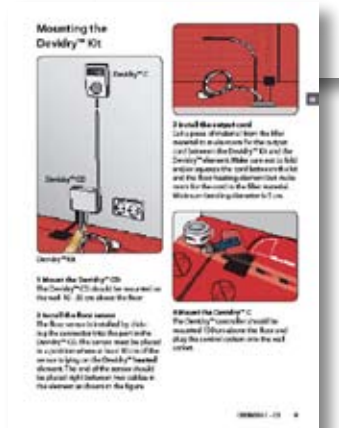

WEALLE